

Piedmont Commons Expansion

The new Piedmont Commons aims to expand the Park further north toward the intersection of Piedmont Avenue and Monroe Drive. Although the City of Atlanta does not yet own the northernmost parcels at the corner of the intersection, this plan shows the 15-20 year vision for the long-term future of the Commons.

Regardless, the expansion will include multiple new play opportunities, a sloped lawn doubling as a natural amphitheater and event space, long pastoral picnic lawns, new concessions and restrooms both near the northern intersection and near the Beltline. All proposed features at the Commons Expansion will be designed in coordination with the City of Atlanta Department of Parks and Recreation and Department of Watershed Management.

PIEDMONT COMMONS EXPANSION LEGEND

- 1 New Entrance and Public Art at Monroe and Piedmont
- 2 Urban Entry Allee and Plaza
- 3 Concessions and Restrooms
- 4 New Playgrounds
- 5 Formal Lawn and Plaza Overlook
- 6 Existing Building and Parking
- 7 Monroe Neighborhood Entrance
- 8 Overlook Terrace and Rock Scramble Through Meadow
- 9 Restroom and Concessions Serving Beltline, Amphitheater, and Play Area
- 10 Beltline Entrance with Bike and Scooter Parking to be Designed in Coordination With Atlanta Beltline Inc.
- 11 Sloped Gathering Lawn and Amphitheater
- 12 Paved Stage
- 13 Adventure Trail
- 14 Connections to Creek Trails
- 15 Pastoral Picnic Lawns
- 16 Enhanced Pedestrian Entrance from Westminster
- 17 Service Road Alignment Under Ongoing Coordination With the Atlanta Botanical Garden and the City of Atlanta Department of Parks and Recreation





Existing Conditions



Piedmont Commons Expansion

ABOUT THE EXPANSION

The City of Atlanta has acquired the land with the large asphalt surface parking lot, the Clear Creek Center at 1529 Piedmont Avenue, and more, with the intent to convert these properties to additional green space.

The recently-built Harry Norman building at 1518 Monroe Drive will remain and be converted into additional administrative offices and programming space for the Piedmont Park Conservancy and its partners. The building will require adequate parking for staff, and the Comprehensive Plan recommends further study of a subgrade parking area behind the building that will meet the parking requirement while occupying the minimum amount of space needed.

NEW PLAY EXPERIENCES

The new play experiences of the Piedmont Commons Expansion are diverse and welcoming to all. These include:

- Creek Playground and Scramble - nature playscape with a creek ecology theme, boulders, climbing, and slides on the existing hill
- Monroe Drive Playground - neighborhood playground adjacent to Morningside-Lenox Park and across from Smith Park, with close access to concessions and restrooms, the 1518 Monroe Drive building offices, and the oval lawn
- Adventure Play Trail - natural play elements and steppers through the existing woodland, with small gathering spaces under the trees

PICNIC LAWNS AND PASSIVE RECREATION

There will be several styles of open lawns for passive recreation, including:

- Long, pastoral Olmsted-like lawns with some trees around the edges for shading
- Formal lawn on axis with the main entrance from the north, with an overlook over Piedmont Park and surrounded by paved seating
- Sloped gathering lawn following existing grade - backdrop of Clear Creek, row of trees surrounding the space for noise buffering

PLANTING CHARACTER

The planting character of the Park will include eye-catching garden plantings visible from the street to draw people into Piedmont Park. Similarly, intentional planting around overlook plazas will frame long views into the Park. Then, added native creek plantings and native woodland plantings will create the feel of a “Northwoods expansion” forest.



Adventure Play Trail, Lakeshore Park, Knoxville, TN (NBW)



Playground, Lakeshore Park, Knoxville TN (NBW)



The Scramble, Memorial Park, TX (NBW)



Prospect Park Long Meadow, NYC (Olmsted)



Formal Lawn and Trees, Memorial Park, Houston TX (NBW)

ENTRANCES, RESTROOMS, AND CONCESSIONS

Drop-off zones at Piedmont and Monroe entrances to keep traffic away from intersection. The restrooms and concessions at this northern entrance near the intersection will support the potential visitor center, food/beverage services, and/or meeting/event spaces. There will also be restrooms to serve new playgrounds and lawns.

The new Beltline entrance on the axis with the oval sloped lawn offers views down to Clear Creek; and relocating existing maintenance facilities provides more space. There will be restroom and food/beverage concessions adjacent to the Beltline entrance, with potential use as Beltline rest stop and bike parking.

PROGRAMMING RECOMMENDATIONS

The sloped oval lawn and formal entry lawns will primarily be used as passive recreation and picnic space. These could also be potentially used for some community gatherings and events as additional rentable lawn space which would take some of the strain off of the existing Promenade event space. Plaza space at the northern entry is another potential space for community and neighborhood events like markets with the added movable seating and space for vendors and gathering.

PUBLIC ART

The plan considers the entry plaza near the intersection of Piedmont Avenue and Monroe Drive as a potential location for public art as part of establishing the northern edge of Piedmont Park. As will all public art installations in the Park, there will be community-oriented selection process and approvals from the City of Atlanta to ensure each piece fits with the context of Piedmont Park and the surrounding neighborhoods.

BELTLINE ACCESS

The plan includes a Beltline entrance plaza with bike and scooter parking for users coming from the north under Piedmont Avenue on axis with the oval sloped lawn offering views all the way down to Clear Creek. This entrance will be coordinated with the future Atlanta Botanical Garden Expansion project, as well as the potential for a future Beltline transit line stop. New alternate, pedestrian-only routes along the Beltline will lead directly into Piedmont Commons from the south.

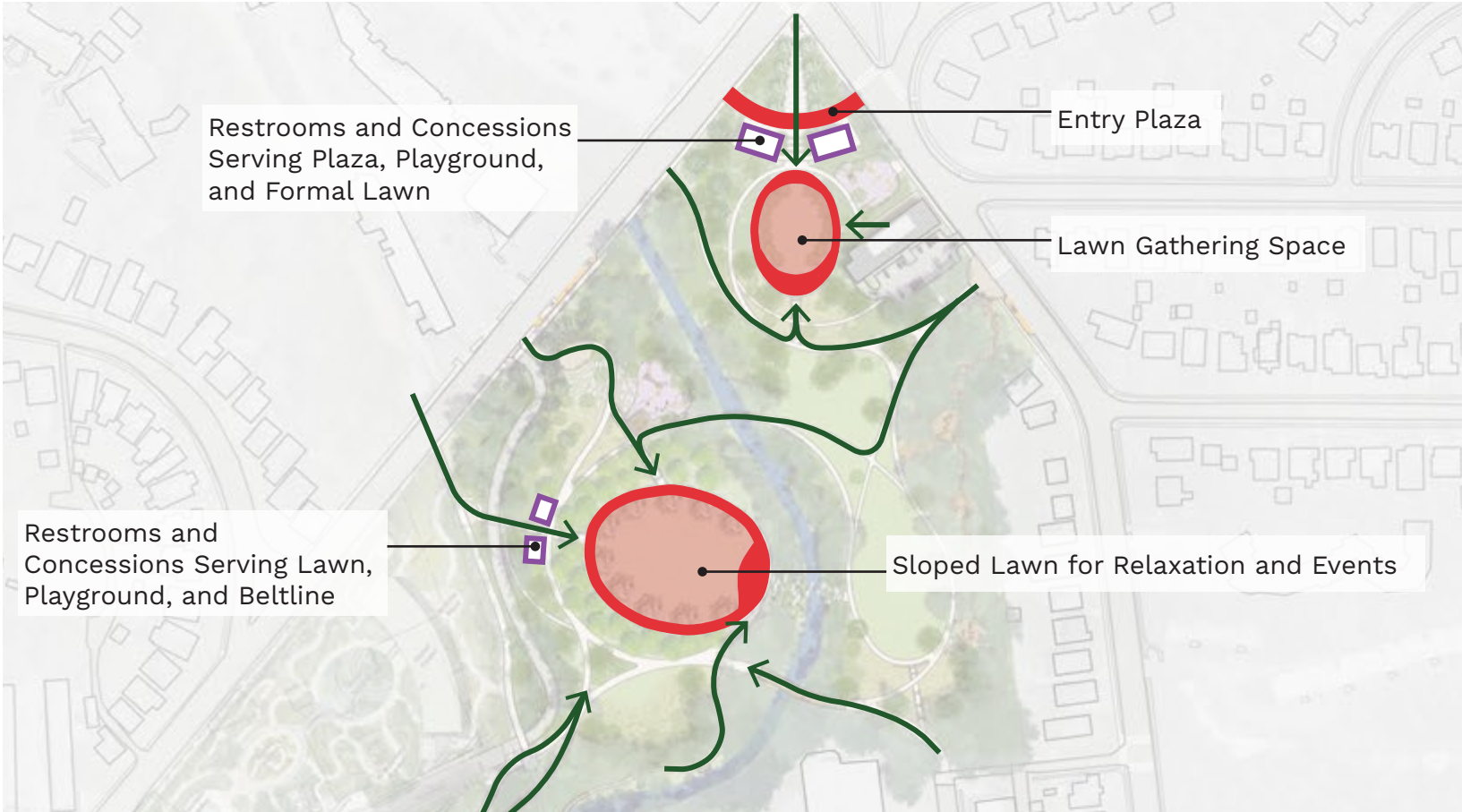

Potential Programming at Piedmont Commons



Food/Beverage Concessions, Memorial Park, Houston, TX (NBW)



Picnic Shelter, Lakeshore Park, TN (NBW)



Public Art, Citygarden, St. Louis, MO (NBW)